

Professional Services



Steininger family owned and operated since 1947, Sko-Die has provided quality custom metal stampings & tooling for our valued customers. With 64,000 square feet of manufacturing space, stamping presses ranging from 5 to 440 tons and an average employee tenure of over 18 years, Sko-Die has the knowledge and resources to make the difference in producing the highest quality parts on time for our customers.

Tool & Die Design

- Combined over 135 years of tool & die design and build experience
- SolidWorks, CAD 2D & 3D Quickpress design software

Tool & Die Production

- High Speed Progressive, Compound, Notching, Fineblanking, and other dies built in house, in a complete tool room
- Agie E.D.M. and Toyoda CNC Machining Center for precise punches and dies

Engineering

- Part application consulting
- Material selection
- Production consulting
- Reverse design production

Production Expertise

- Progressive Stamping
- Compound Dies
- Fineblanking
- Welding
- Wire Cutting
- Kan Ban & Vendor Managed Inventory
- Blanking
- Notching
- Laser Cutting
- Machining

Quality Control

- ISO 9001 since 1997- DNV Registrar

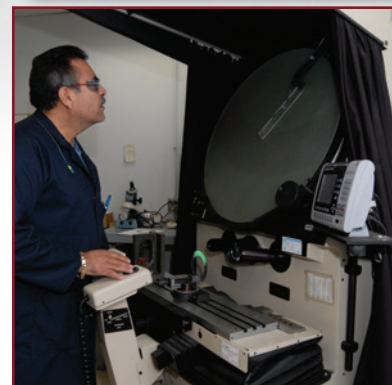
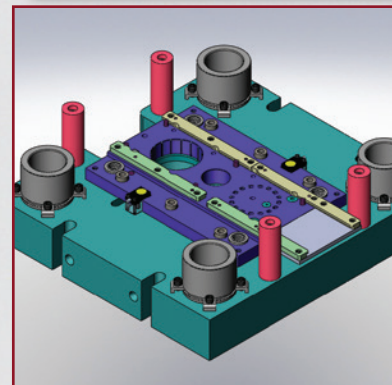
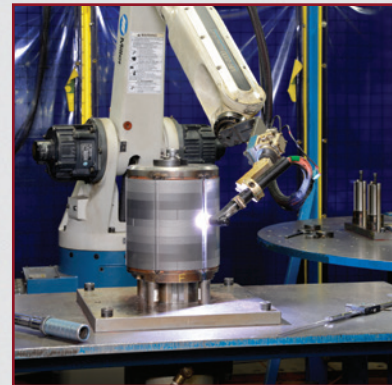

8050 Austin Avenue • Morton Grove, Illinois 60053
800-486-4756 • F. 847-966-0322
www.skodie.com